

PORTA-DOCK, INC.
74A ABL/APW 1056 & 44A FLB APW 1056 PORTA-LIFT

Thank you for purchasing a Porta-Dock product!
Please read and follow these instructions step by step

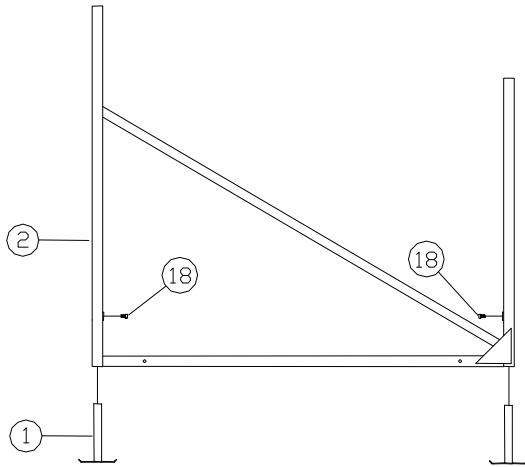

STEP 1. Separate and group like parts and fasteners together. Locate the four leveling legs with pads (**REF. # 1**) and the two side members (**REF. # 2**). Slide the leveling legs into the front and rear upright tubes of the side members and secure with 1/2" X 3/4" set screws (**REF. # 18**). Set the side members about 56" apart.

STEP 2. Locate the two H shaped lifting arms, the ones with the extra set of holes toward the end of the arms is the front (**REF. # 3**). The other is the rear (**REF. # 4**). Lay the front lifting arm between the two side members with the extra holes facing the rear of the lift and the bottom of the arms along side the bottom holes of the side members. Lay the rear lifting arm between the back holes of the side member. Secure the lifting arms to the side members by placing a 5/8" X 1 1/2" nylon spacer washer (**REF. # 19**). Between the side member and the lifting arm legs. Place a 1/2" washer on a 1/2" X 4 1/2" bolt (**REF. # 34 & 33**). From the outside pass the bolt through the hole in the bottom side member hole through the spacer and lifting arm, secure with 1/2" washer and 1/2" nylock nut (**REF. # 34 & 36**). Tighten nut until arm is tight against spacer and side member, but can still pivot freely.

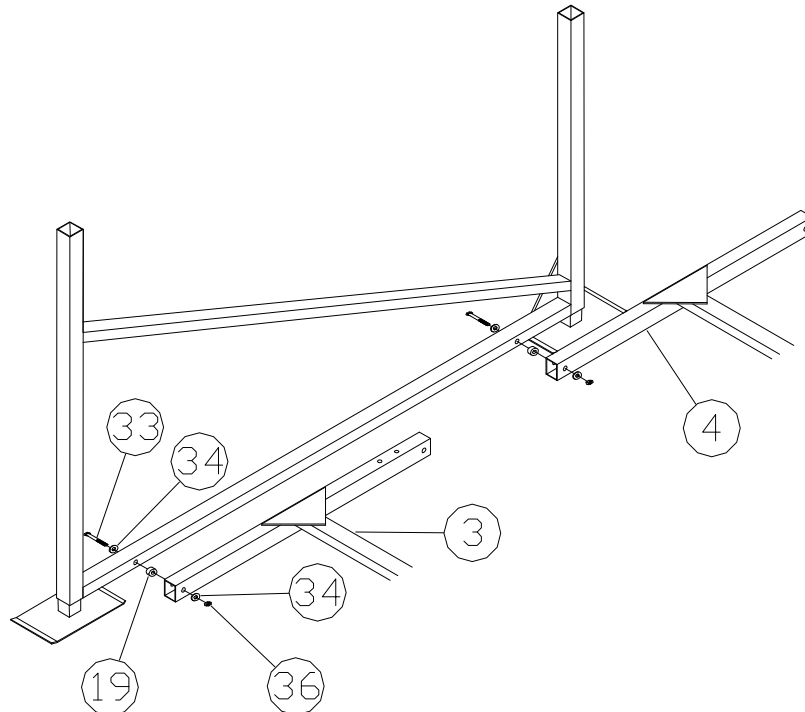

STEP 3. Find the front cross brace tube (**REF. # 5**) and place it onto the top of the bottom side tubes of the side members and bolt it to the holes using 3/8" X 5" bolts, washers, and nuts (**REF. # 21, 20, & 24**).

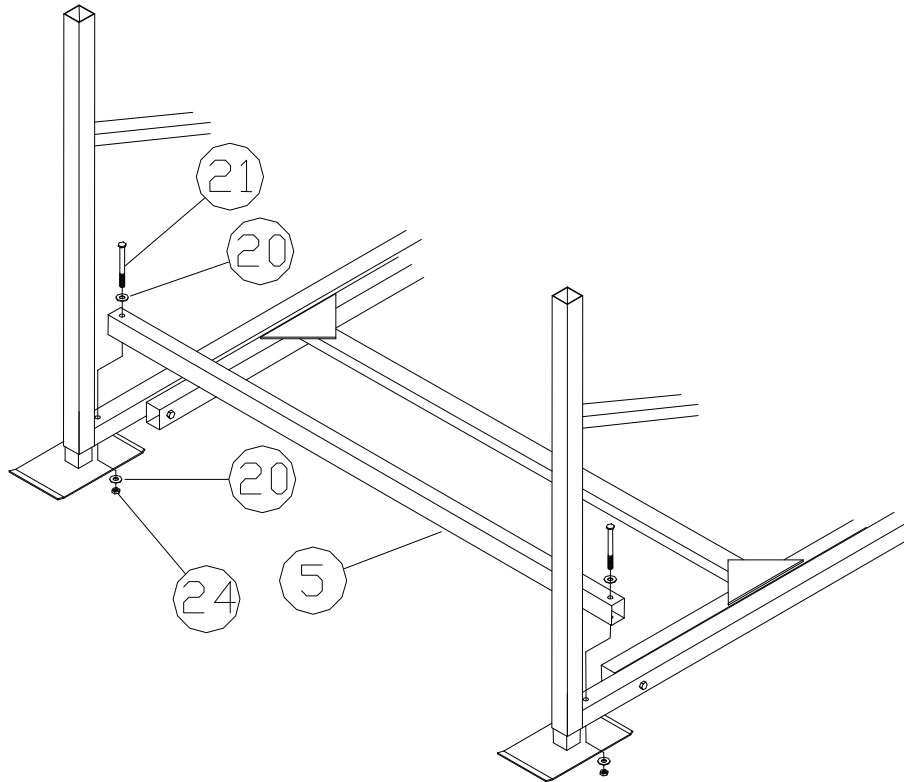

STEP 4. Locate the top bed member (60" X 50 1/4" Rectangular Frame) (**REF. # 6**) set the bed between the tops of the lifting arm legs. Place a nylon spacer washer (**REF. # 19**) between the lifting arm and the top bed and fasten with a 1/2" X 4 1/2" bolt, washers, and nylock nut (**REF. # 33, 34, & 36**).

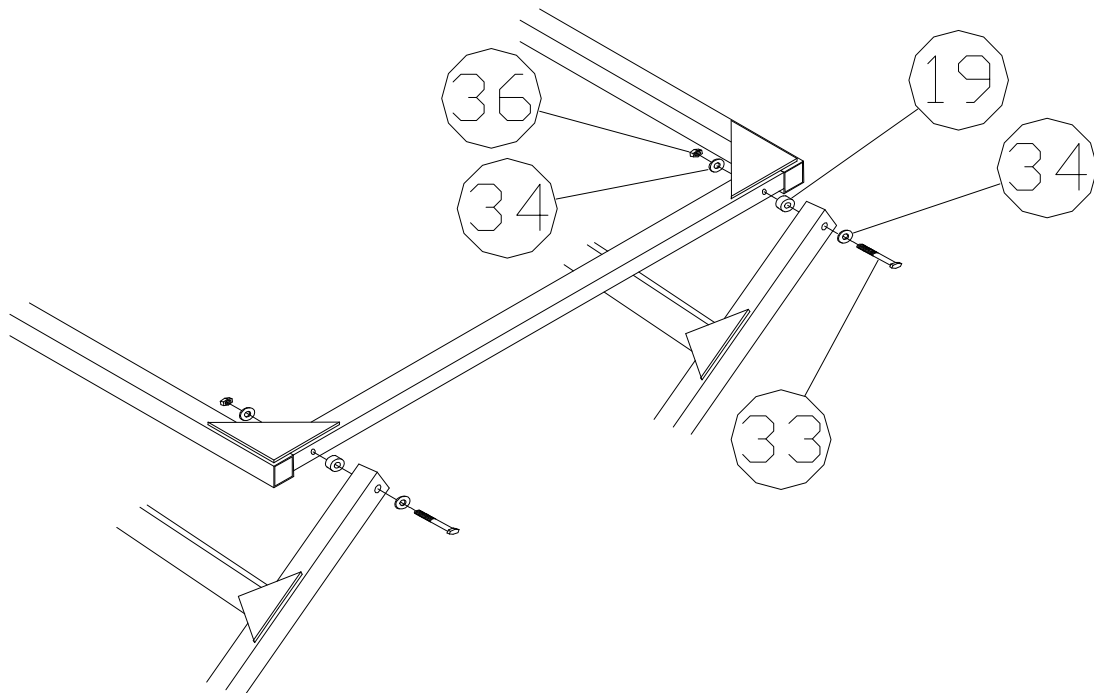

STEP 5. Decide which front upright tube the winch will be on, and bolt the pulley (**REF. # 14**) into the holes above the side brace with a U-bolt, large 3/8" fender washers, and nuts (**REF. # 13, 25, & 22**). Place bolt caps (**REF. # 35**) onto the threads of the U-Bolt. Bolt a U-bolt (**REF. # 13**) to the other front upright in this same manner. Now, working on the same side as what the winch will be on, find a 3/8" U-bolt, pulley, and chain stop (**REF. # 13, 14, & 15**). Place a U-bolt through the swivel eye of the pulley and fasten to the two holes on the front lifting arms with a 3/8" fender washer and nylock nut (**REF. # 25 & 22**) on the top of the U-bolt and a 3/8" fender washer and nut (**REF. # 25 & 24**) on the bottom of the U-bolt. Place a 3/8" washer on the bottom leg of the U-bolt and fasten one end of the chain stop to the bottom leg of the U-bolt with another 3/8" washer and nylock nut (**REF. # 20 & 22**). Bolt the remaining pulley and U-bolt to the other lifting arm leg. Bolt the bottom cross brace angle (**REF. # 7**) to the center holes of the bottom tube of the side members using a 5/16" X 2 1/2" bolt, washers, and nuts (**REF. # 26, 27, & 28**). On the stop chain side of the lift, place the bolt and washer (**REF. # 26 & 27**) through the chain first and then the angle and side member.

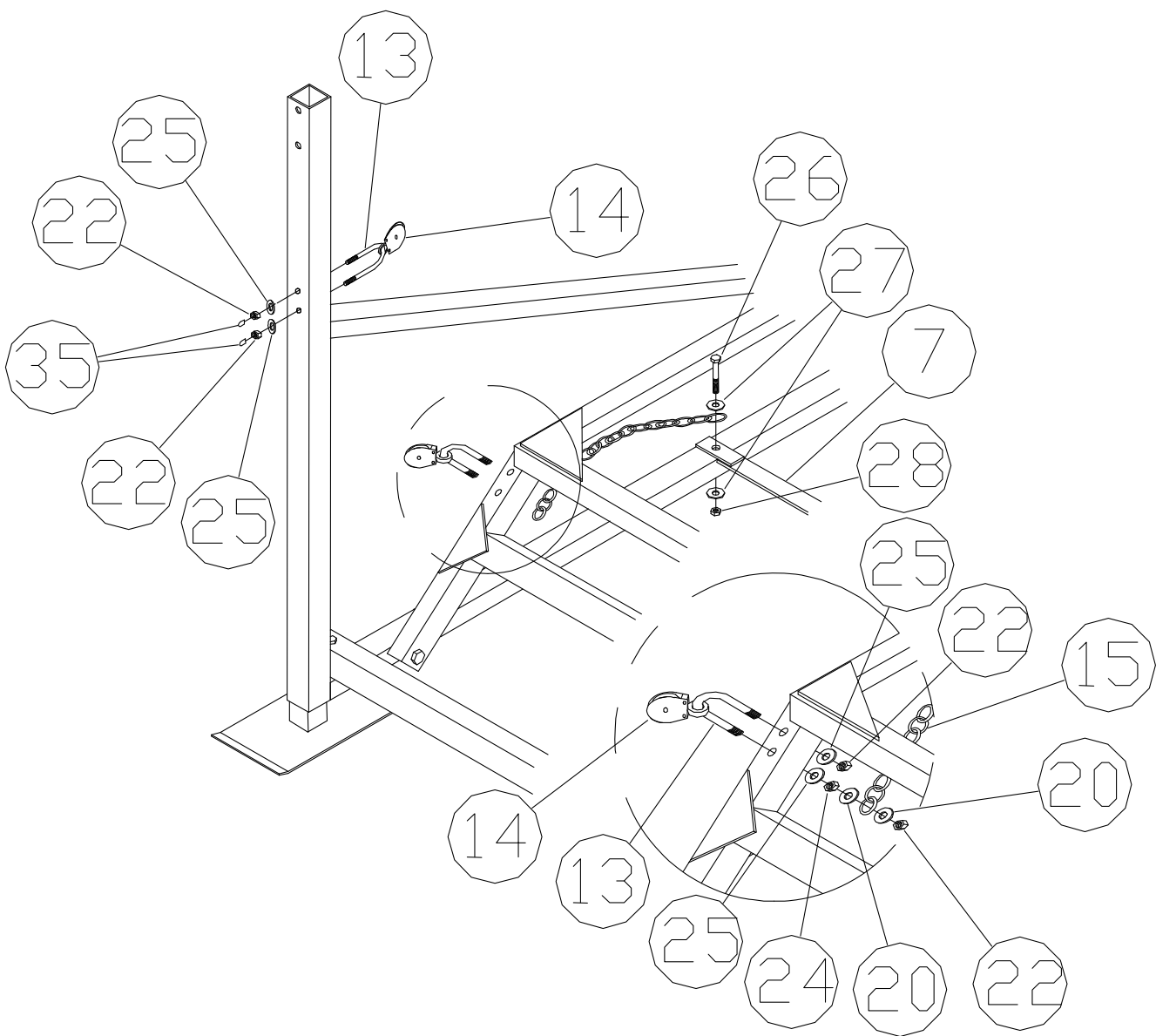

STEP 6. Slip the cable thimble (**REF. # 16**) through the U-bolt. Attach the winch (**REF. # 8**) to the upright with the pulley assembly, with two 3/8" X 2 1/2" bolts, washers, fender washers, and nuts (**REF. # 23, 20, 25, & 24**). Winch should face to the inside of lift. Next pass the cable (**REF. # 9**) through the hole on the side of the winch drum. Now pass the cable through the pulley below the winch, run the cable through the pulley on the lifting arm and across through the other pulley. Now run it around the cable thimble in the eyebolt and secure with a 3/16" cable clamp (**REF. # 17**) Attach the winch wheel (**REF. # 10**) to the winch with the winch hardware.

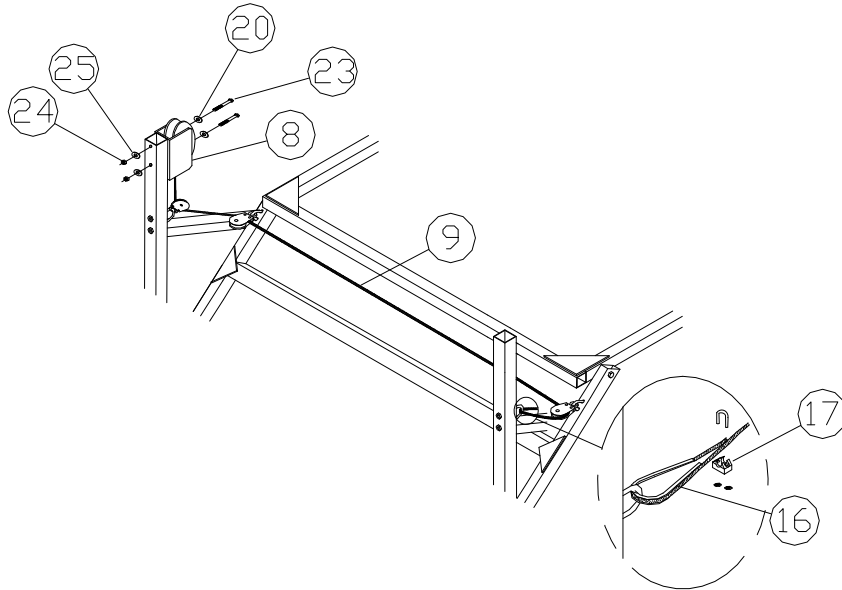

STEP 7. Find the two front angle braces (**REF. # 37**) (description 1 1/4" X 1 1/4" X 26 3/4" angle with slotted holes on each end) Bolt the one end to the inside face of the front upright tube with a 3/8" X 2 1/2" bolt, washer, and nut (**REF. # 23, 20, & 24**). Bolt the other end to the side of the bottom cross tube using the same size bolt, washers, and nuts. Tighten up the bottom cross member nut first so that the bottom of the slot is tight to the bottom of the bolt. Adjust the uprights so that they are 1/2" wider at the top than the bottom and tighten the bolt in the upright tube.

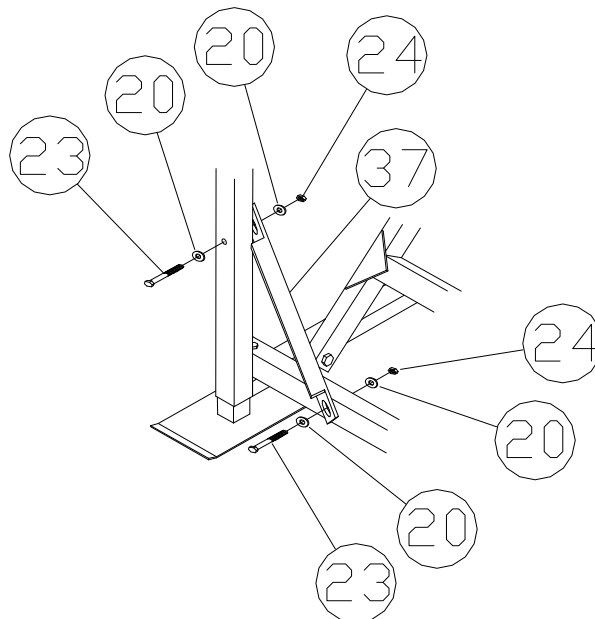

STEP 8. Bolt the 6" bunk mounting angles (**Ref. #11**) to the bed of the lift as shown, using square 3/8" X 2" U-bolts, 3/8" washers, and nuts (**Ref. #31, 20 & 24**). Leave loose at this time.

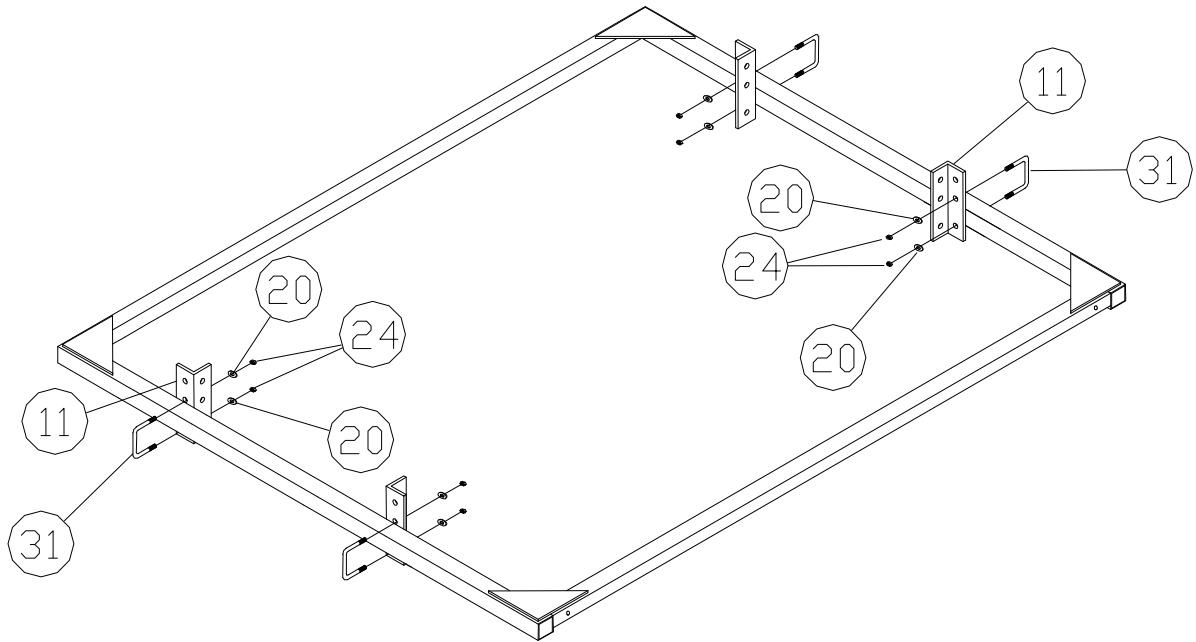

STEP 9A. Model 27A Bolt the 2" X 4" X 6' bunk (**Ref. # 12A**) to the inside of the bunk mounting angles as shown using 3/8" X 2 1/2" carriage bolt, 3/8" washer, and nuts (**Ref. #29, 20 & 24**). Set bunks to the desired width and tighten U-bolts.

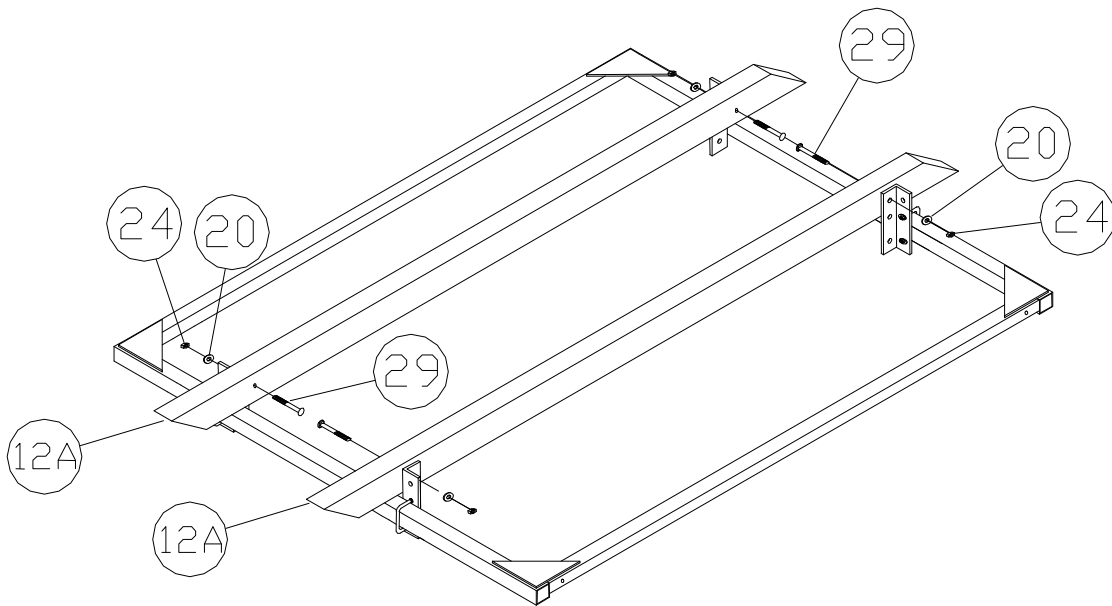

STEP 9B. Model 87A Bolt the full length bunk (**Ref. #12B**) to the bunk mounting angles as shown, using 3/8" X 1 1/2" bolts, 3/8" washers, and nuts (**Ref. # 32, 20, & 24**). Set bunks to the desired width. Tip the bunks inward and tighten all bolts at this time.

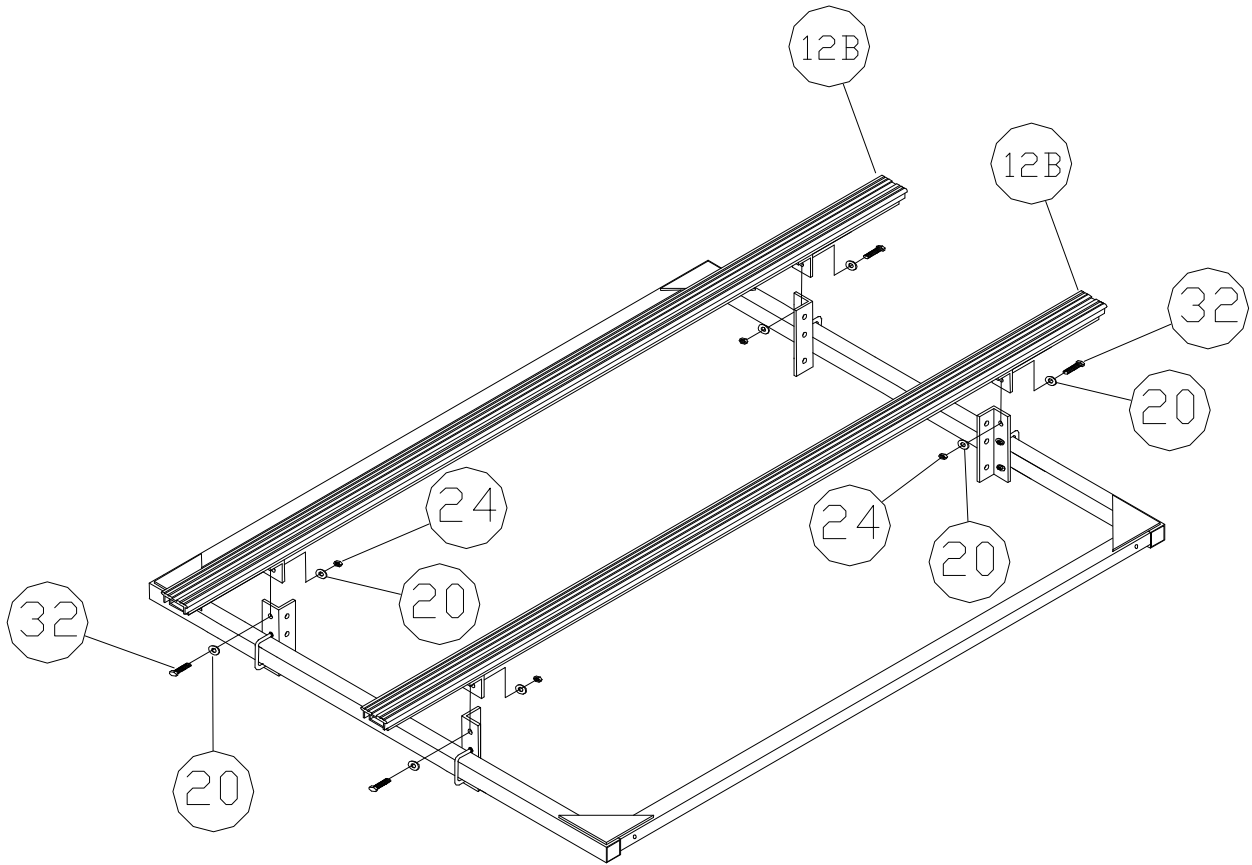

74A ABL/APW 1056 & 44A FLB APW PORTA LIFT

REF. NO	PART NO.	DESCRIPTION	44A.	74A
1	60Q	LEVELING LEGS	4	4
2	69E	RIGHT SIDE MEMBER 1056	1	1
	70E	LEFT SIDE MEMBER 1056	1	1
3	67E	LIFTING ARM FRONT	1	1
4	68E	LIFTING ARM REAR	1	1
5	70130	FRONT CROSS BRACE	1	1
6	71E	1056 BED MEMBER FRAME	1	1
7	70131	BOTTOM CROSS BRACE	1	1
8	3180	WINCH DL1200A	1	1
9	3050	CABLE 3/16" X 15'	1	1
10	23E	LIFT WHEEL	1	1
11	60200	853/1056 BUNK MOUNTING ANGLE	4	4
12A	70024	BUNK 2" X 4" X 6"	2	-
12B	14F	ALUM BUNK W/VINYL PAD	-	2
13	5034	U-BOLT 3/8" X 2 1/4" X 4"	4	4
14	3302	PULLEY SWIVEL EYE BLOCK 2"	3	3
15	3188	CHAIN 3/16" X 31 LINK	1	1
16	5043	CABLE THIMBLE 3/16"	1	1
17	5003	CABLE CLAMP 3/16"	1	1
18	5170	SET SCREW 1/2" X 3/4"	4	4
19	3325	WASHER/SPACER NYLON 5/8" X 1 1/2"	8	8
20	5070	WASHER 3/8"	32	32
21	5090	BOLT 3/8" X 5"	2	2
22	5038	NUT NYLOCK 3/8"	12	12
23	5083	BOLT 3/8" X 2 1/2"	6	6
24	5056	NUT 3/8"	17	17
25	5067	WASHER FENDER 3/8"	10	10
26	5157	BOLT 5/16" X 3"	2	2
27	5068	WASHER 5/16"	4	4
28	5054	NUT 5/16"	2	2
29	5195	BOLT CARRIAGE 3/8" X 2 1/2"	4	-
30	3815	CAP 1.75" SQ.	3	3
31	5046	U-BOLT SQUARE 2"	4	4
32	5155	BOLT 3/8" X 1 1/2"	-	4
33	5113	BOLT 1/2" X 4 1/2"	8	8
34	5071	1/2" WASHER	16	16
35	3828	3/8" BOLT CAP	4	4
36	5039	1/2" NYLOCK NUT	8	8
37	70120	1056/1265 DIAGONAL BRACE	2	2

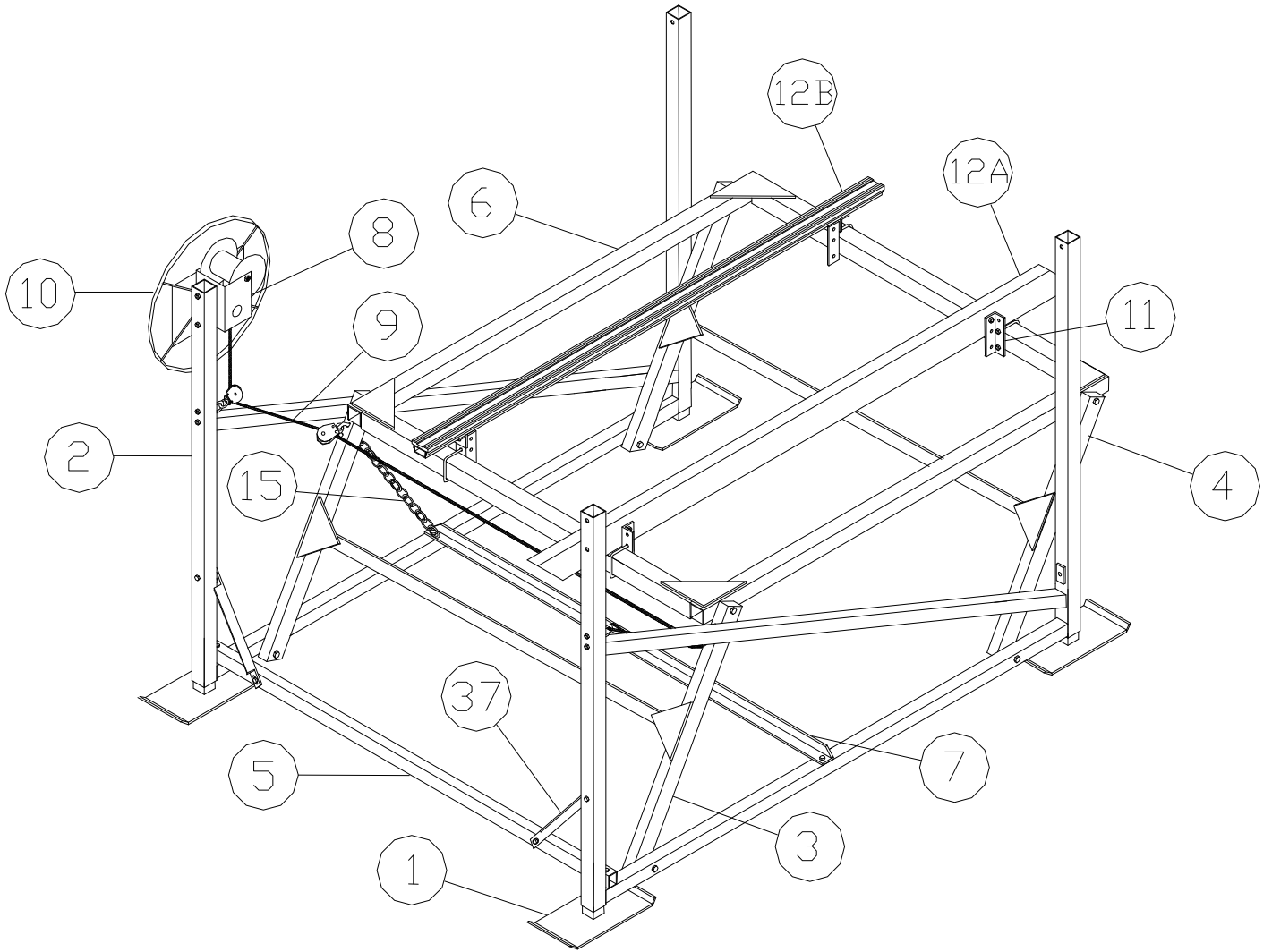



IMPORTANT BOAT LIFT SAFEGUARDS

The boat lift system must be assembled, installed and operated correctly or mechanical failure causing injury or death may occur. Be sure that all persons operating the lift are familiar with the correct operating procedures and safety guidelines.

CAUTION - Keep all body parts inside the boat when entering or exiting the boat lift. Do not try to manually guide the boat into position.

CAUTION – Keep clear of chains, cables, and all moving parts when operating the lift.

CAUTION – On lifts that have a chain drive winch, the cover must be in place while operating.

CAUTION – Never allow anyone to swim around or climb on the lift structure at any time.

CAUTION – Do not operate the lift with people inside the boat.

CAUTION – Never exceed the rated capacity of the lift as this may cause excessive damage to the lift. Do not allow people to sit in a boat that is on the lift as this may cause the lift's capacity to be exceeded. An uncovered boat can fill up with water and cause the capacity of the lift to be exceeded.

CAUTION – Before any adjustments are made to the lift, or any work is done, the boat must be removed and the bed must be fully lowered.

CAUTION – Winches are pre set from the manufacturer and do not need adjusting.

CAUTION – If using a winch with a remote control, the operator must be close enough to the lift to be sure that no one is around or on the lift, and to be sure that the lift is operating properly

CAUTION - After installation the lift must be leveled in order to operate properly. If the lift is not leveled properly there will be excessive stress on isolated areas causing failure or damage to the lift.

Before installing the lift each year inspect the cables, pulleys, and all moving parts for wear. Immediately replace any part that has excessive wear. Check the brake pad in the winch, if it is worn down to 1/16" thick, cracked, or glazed over, replace it immediately. Check all the bolts to make sure they are tight. On vertical lifts the cables may stretch and will need to be tightened so there is equal tension on all the cables.

Porta-Dock, Inc.