

PORTA-DOCK, INC.
PONTOON BUNKS

K99 3-4600 DPB **K95** FPB DOUBLE 136.5" **K96** FPB DOUBLE 156"
K110 6000 FPB **K97** FPB TRIPLE 136.5" **K98** FPB TRIPLE 156"

Thank you for purchasing our product!

***Please read these instructions and follow them step by step.**

DPB 2000-4600 Cantilever and Vertical

Find the four bottom mounting brackets (large channel with an upright tube in the center) (**Ref. # 1**), set the bottom brackets over the top cross tubes of the lift. Place 3/8" x 3" bolts (**Ref. # 15**) into the bottom holes and secure with washers and nuts (**25 & 21**). Set according to inside width of pontoon floats and tighten nuts.

Locate the top rail bracket (angle with a tube in the center) (**Ref. # 2**) with the tube of the top bracket to the inside of the lift, place the rail bracket into the tubes of the bottom mounting bracket.

Bolt the long 2" x 8" x 14' rail boards (**Ref. # 10**) to the side of the top rail bracket with 3/8" x 2 1/2" carriage bolts, washer and nut (**Ref. # 17, 25, & 21**). Have the 45 degree cut end of the rail board to the back of the lift.

Place the 1/2" x 1" set screws (**Ref. # 20**) into the bottom mounting brackets. Set to height (usually 1" to 2" higher than the pontoon floats) and tighten set screws.

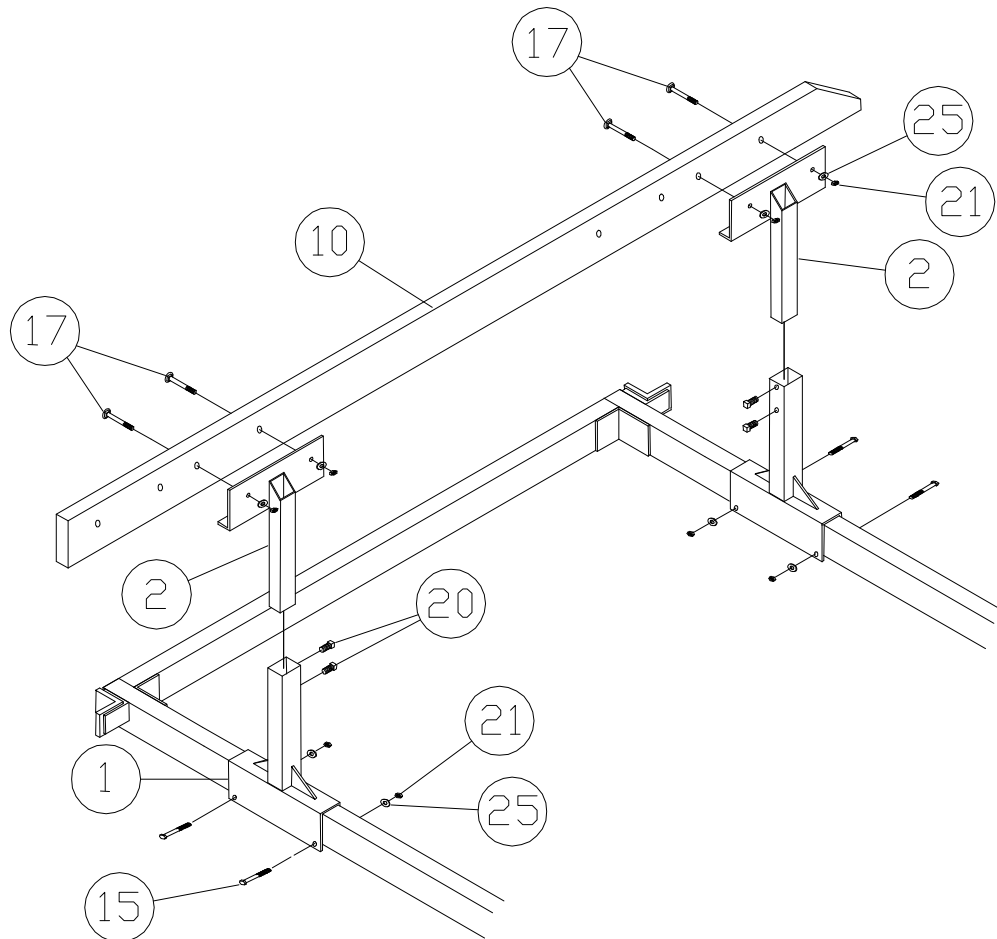

FPB 2000-4600 Cantilever & Vertical

Raise the bed of the lift to working height. Set the bunk brackets (**REF. # 3**) over the front and rear cross bars of the lifts bed with the pockets toward the center of the lift. Set to desired width and secure with 3/8" X 3" bolts, washers, and nuts (**REF. # 15, 25, & 21**).

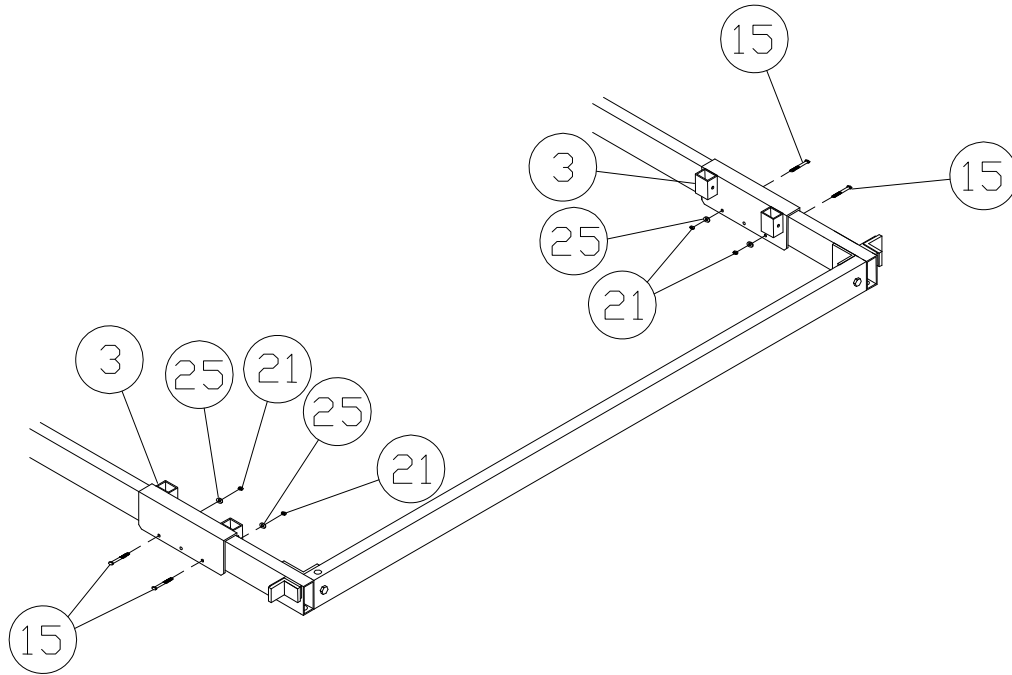

Step 12. Place the bunk uprights (**REF. # 9**) into the pockets set to desired height and secure with a 1/2" X 1" set screw (**REF. # 20**). Place the bunk (**REF. # 13**) on the uprights with the tapered end toward the back of the lift. Secure with 3/8" X 2 1/2" bolts, washers, and lock nuts (**REF. # 16, 25, & 22**). Tip bunks inward slightly and tighten bolts so that the bunks will not turn freely but can pivot when weight is applied.

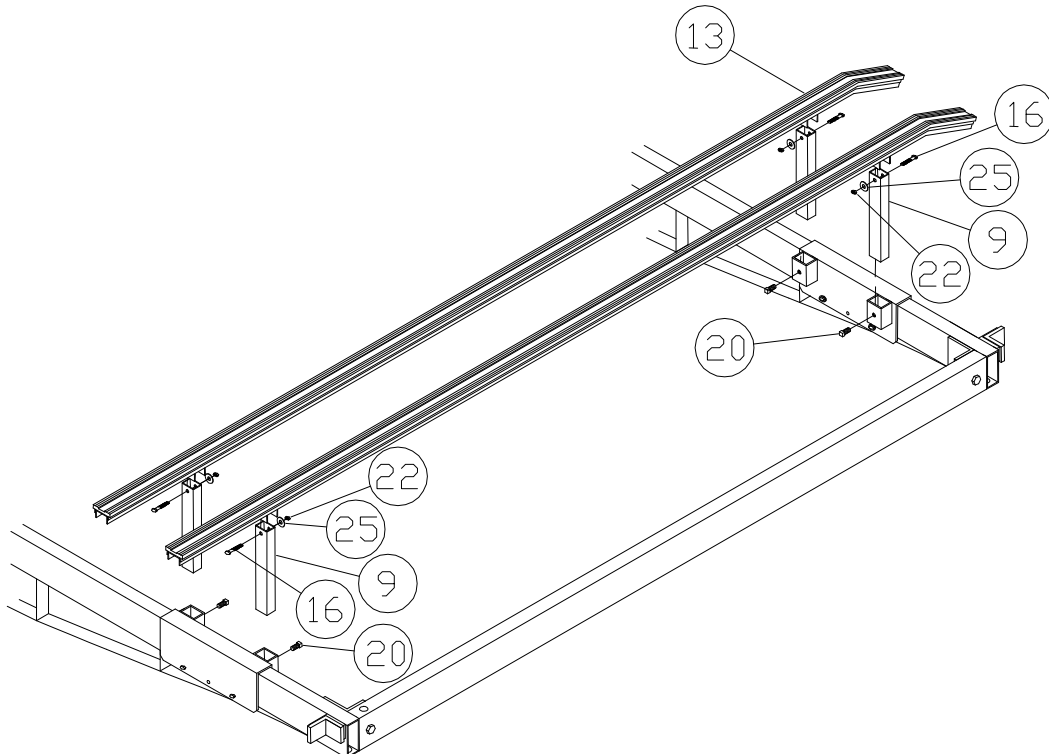

FPB 6000 Vertical

Raise the bed of the lift to working height. Find the four FPB bunk brackets and backer plates (**Ref. # 4 & 5**) and bolt to the bed of the lift as shown with the pockets facing the center of the lift using 1/2" X 3 1/2" bolts, washers, and nuts (**Ref. # 18, 26, & 23**). Set to desired width and secure.

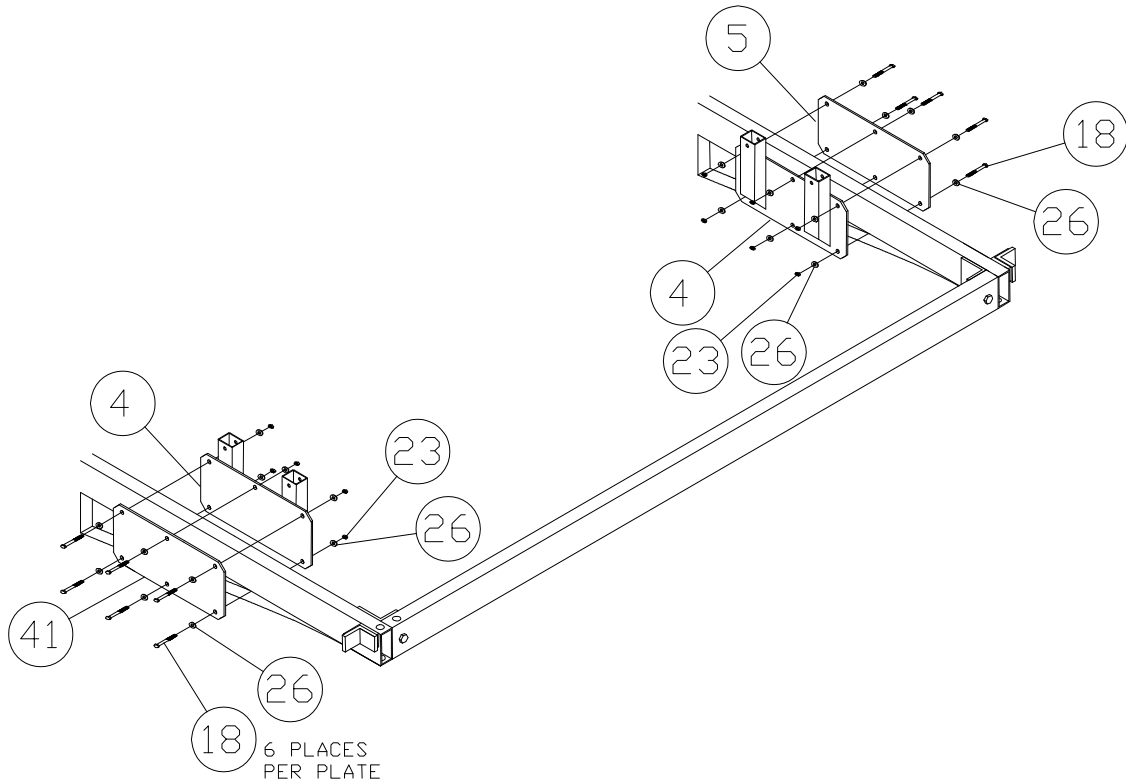

STEP 12. Place the bunk (**Ref. # 14**) on the uprights, with the tapered end toward the end of the lift where the back of the pontoon will be. Secure with 1/2" X 3 1/2" bolts, washers, and lock nuts (**Ref. # 18, 26, & 24**). Tip bunks inward slightly and tighten bolts so that the bunks will not turn freely but can pivot when weight is applied.

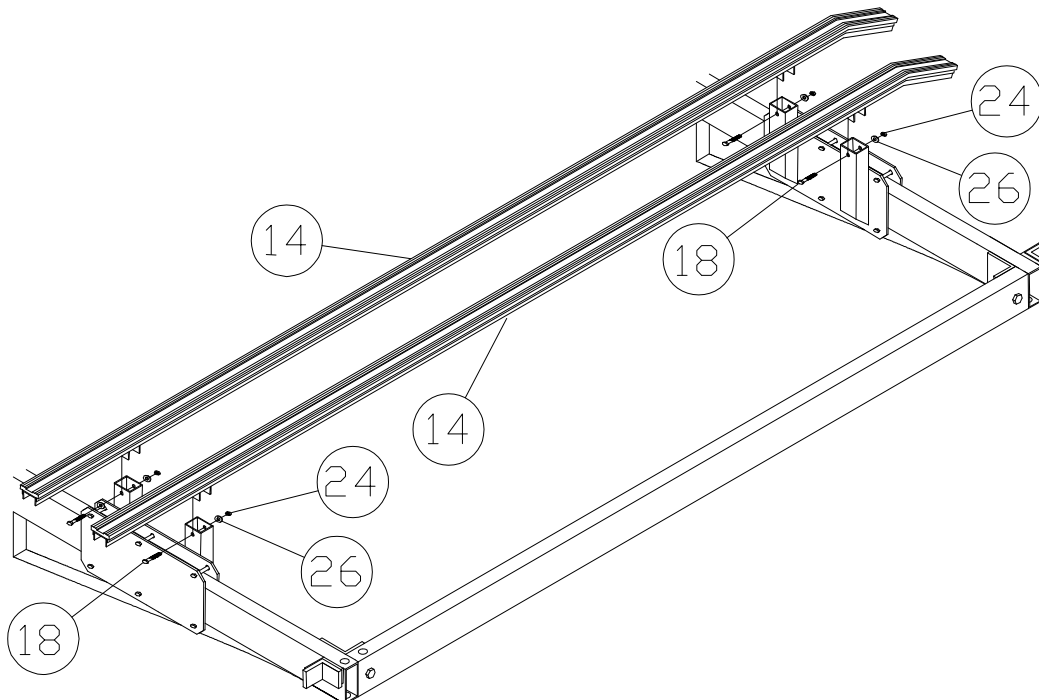

PARTS LIST

BUNKS

<u>REF.</u> <u>#</u>	<u>PART</u> <u>NO.</u>	<u>DESCRIPTION</u>	<u>3-4600</u> <u>DPB</u>	<u>3-4600</u> <u>FPB</u>	<u>3-4600</u> <u>TRIPLE</u>	<u>6000</u> <u>FPB</u>
1	11C	DPL BOTTOM BRACKET	4	-	-	-
2	12L	TOP RAIL BRACKET	4	-	-	-
3	48F	BUNK BRKT DOUBLE FPB	-	4	6	-
4	15Q	BUNK BRKT FPB 60120V	-	-	-	4
5	30808	BUNK BRKT BACKER FPB 60120V	-	-	-	4
6	18Q	BUNK BRKT 60120V	-	-	-	-
7	30810	BUNK BRKT BACKER PLATE 60120V	-	-	-	-
8	19Q	PONTOON RAIL TOP BRACKET 60120V	-	-	-	-
9	50020	BUNK UPRIGHT	-	8	12	-
10	50200	PONTOON RAIL BUNK	2	-	-	-
11	50210	PONTOON RAIL BUNK 60120V	-	-	-	-
13	87C	BUNK & PAD 156"	-	4	6	-
13	65C	BUNK & PAD 136.5"	-	4	6	-
14	98C	BUNK & PAD 168"	-	-	-	4
15	5084	BOLT 3/8 X 3	8	8	12	-
16	5083	BOLT 3/8 X 2 1/2	-	8	12	-
17	5195	CARRIAGE BOLT 3/8 X 2 1/2	8	-	-	-
18	5121	BOLT 1/2 X 3 1/2	-	-	-	32
19	5208	BOLT 1/2 X 2 1/2 CARRIAGE BOLT	-	-	-	-
20	5174	SET SCREW 1/2	8	8	12	-
21	5056	3/8 NUT	16	8	12	-
22	5038	3/8 NYLOCK NUT	-	8	12	-
23	5058	1/2 NUT	-	-	-	24
24	5039	1/2 NYLOCK NUT	-	-	-	8
25	5070	3/8 WASHER	16	16	24	-
26	5071	1/2 WASHER	-	-	-	32